

Kodiak MKVI

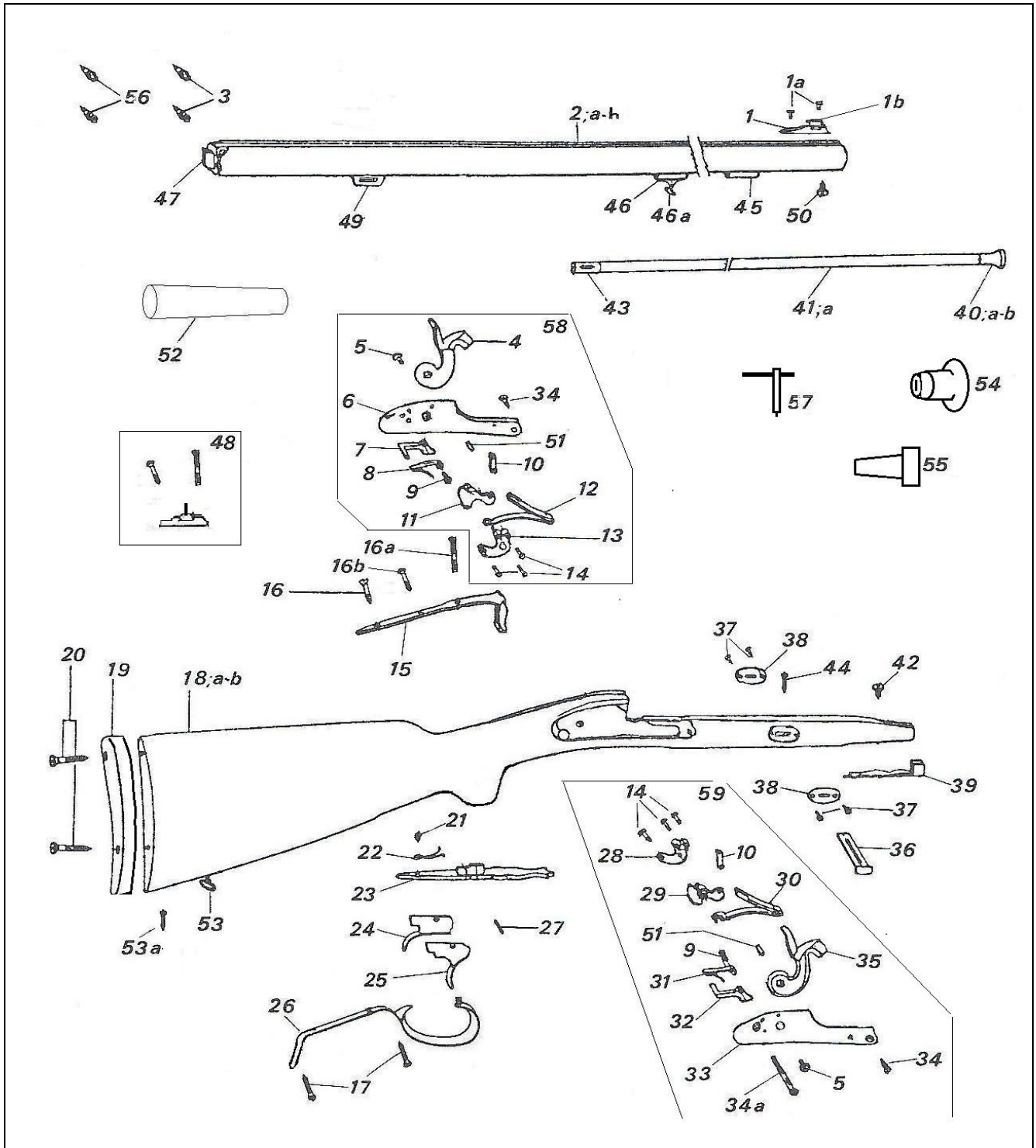

| Nomenclatura / List / Liste | | | | Codice Reference |
|------------------------------------|--|---------------------------------|---|-----------------------------|
| No. | Italiano | English | Français | Référence |
| 1 | Base Mirino kodiak | Front sight base | Base Guidon | 0800004124 |
| 1a | Vite fissaggio mirino | Front sight screw | Vis de fixation guidon | M70PFC5414 |
| 1b | Mirino Kodiak (h 12) | Front sight (h 12) | Guidon (h 12) | 0800004017 |
| 2 | Canne cal. .50 (615 mm) | Barrels .50 cal. | Canons Cal 50 | 0800007272 |
| 2a | Canne cal. .54 (615 mm) | Barrels .54 cal. | Canons Cal 54 | 0800007279 |
| 2b | Canne cal. .58 (615 mm) | Barrels .58 cal. | Canons Cal 58 | 0800007280 |
| 2f | Canne cal. .50 (615 mm) complete | Barrels .50 cal. with spares | Canons Cal 50 complètes | 080007272B |
| 2g | Canne cal. .54 (615 mm) complete | Barrels .54 cal. with spares | Canons Cal 54 complètes | 080007279B |
| 2h | Canne cal. .58 (615 mm) complete | Barrels .58 cal. with spares | Canons Cal 58 complètes | 080007280B |
| 3 | Luminello | Nipple | Cheminée | 0800003407 |
| 4 | Cane sinistro | Left hammer | Chien gauche | 0800007256 |
| 5 | Vite cane | Hammer screw | Vis du chien | M70TFC5483 |
| 6 | Cartella sinistra | Left lock plate | Platine gauche | 0800002419 |
| 7 | Leva scatto sinistra | Left sear | Gâchette gauche | 0800003412 |
| 8 | Molla leva scatto sinistra | Left sear spring | Ressort de gâchette gauche | 0800003618 |
| 9 | Vite molla leva scatto | Sear spring screw | Vis du ressort de gâchette | M70TFM5310 |
| 10 | Tirantino | Stirrup | Chainette | 0800004804 |
| 11 | Noce sinistra | Left tumbler | Noix gauche | 0800003904 |
| 12 | Molla cane sinistra | Left mainspring | Grand ressort gauche | 0800003617 |
| 13 | Braghetta sinistra | Left bridle | Bride gauche | 0800002211 |
| 14 | Vite braghetta | Bridle screw | Vis de bride | M70TFM5524 |
| 15 | Codetta | Tang | Queue de culasse | 0800002451 |
| 16 | Vite posteriore codetta | Rear and middle tang screw | Vis postérieure et intermédiaire de queue | M70LFC5388 |
| 16a | Vite anteriore codetta (*) | Front tang screw | Vis antérieure de queue de culasse | M70TFM5548 |
| 16b | Vite intermedia codetta (*) | Rear and middle tang screw | Vis postérieure et intermédiaire de queue | M70LFC5388 |
| 17 | Vite guardamano | Trigger guard screw | Vis du pontet | M70LFC5392 |
| 18 | Calcio | Stock | Monture | 0800003975 |
| 18a | Calcio completo | Stock with spares | Monture complète | 080003975B |
| 19 | Calciolo | Butt plate | Plaque de couche | 0800007253 |
| 20 | Vite calciolo | Butt plate screw | Vis de plaque de couche | M70LFC5395 |
| 21 | Vite molla grilletti | Triggers spring screw | Vis du ressort des détentés | M70TFC5205 |
| 22 | Molla grilletti | Triggers spring | Ressort des détentés | 0800003672 |
| 23 | Sottoguardia | Trigger plate | Sous-garde | 0800004603 |
| 24 | Grilletto sinistro | Left trigger | Détente gauche | 0800003007 |
| 25 | Grilletto destro | Right trigger | Détente droite | 0800003006 |
| 26 | Guardamano | Trigger guard | Pontet | 0800003214 |
| 27 | Copiglia grilletti | Triggers pin | Goupille des détentés | M70COP5521 |
| 28 | Braghetta destra | Right bridle | Bride droite | 0800002209 |
| 29 | Noce destra | Right tumbler | Noix droite | 0800003902 |
| 30 | Molla cane destra | Right mainspring | Grand ressort droite | 0800003607 |
| 31 | Molla leva scatto destra | Right sear spring | Ressort de gâchette droite | 0800003612 |
| 32 | Leva scatto destra | Right sear | Gâchette droite | 0800003411 |
| 33 | Cartella destra | Right lock plate | Platine droite | 0800002416 |
| 34 | Vite anteriore cartella | Front lock plate screw | Vis antérieure de platine | M70LFC5285 |
| 34a | Vite posteriore cartella | Rear lock plate screw | Vis postérieure de platine | M70TFM5534 |
| 35 | Cane destro | Right hammer | Chien droite | 0800007257 |
| 36 | Chiavetta | Wedge | Clavette | 0800002425 |
| 37 | Vite piastrina chiavetta | Wedge plate screw | Vis de plate de clavette | M70LFC5285 |
| 38 | Piastrina chiavetta | Wedge plate | Plate de clavette | 0800004211 |
| 39 | Ghiera posteriore | Rear thimble | Busette postérieure | 0800004608 |
| 40 | Puntale anteriore bacchetta (cal. .50) | Front ramrod tip (.50 cal.) | Refouloir (Cal 50) | 0800004218 |
| 40a | Puntale anteriore bacchetta (cal. .54) | Front ramrod tip (.54 cal.) | Refouloir (Cal 54) | 0800004218 |
| 40b | Puntale anteriore bacchetta (cal. .58) | Front ramrod tip (.58 cal.) | Refouloir (Cal 58) | 0800004220 |
| 41 | Bacchetta completa (cal..50/.54) | Ramrod with tips (.50/.54 cal.) | Baguette complète (Cal 50/54) | 0800001884 |
| 41a | Bacchetta completa (cal. .58) | Ramrod with tips (.58 cal.) | Baguette complète (Cal 58) | 0800001885 |
| 42 | Vite ghiera posteriore | Rear thimble screw | Vis de busette postérieure | M70TFC5413 |
| 43 | Puntale posteriore bacchetta | Rear ramrod tip | Embout postérieur de baguette | 0800004214 |
| 44 | Vite chiavetta | Wedge retaining screw | Vis de clavette | M70LFC5383 |
| 45 | Ghiera anteriore | Front thimble | Busette anteriore | 0800004815 |
| 46 | Ghiera intermedia | Middle thimble | Busette intermédiaire | 0800004816 |
| 46a | Portacinghia anteriore | Front swivel | Battant antérieur | 0800004301 |
| 47 | Tappo canna | Breech plug | Bouchon de culasse | 0800004917 |
| 48 | Diottra Ghost x MKVI | Rear sight base | Embase du cran de mire | USA 422 M |
| 49 | Tenone chiavetta | Wedge staple | Tenon de clavette | 0800005026 |
| 50 | Vite fermo bacchetta | Ramrod retaining screw | Ressort arrêt baguette | M70PFC5403 |

| Nomenclatura / List / Liste | | | | Codice Reference Référence |
|------------------------------------|-------------------------------|------------------------|-------------------------------|---|
| No. | Italiano | English | Français | |
| 51 | Perno molla cane | Mainspring screw | Vis du grand ressort | M70SPC5233 |
| 52 | Piombo | Lead | Plombs | 0800004244 |
| 53 | Portacinghia posteriore | Rear swivel | Battant postérieur | 0800004301 |
| 53a | Vite portacinghia | Swivel screw | Vis porte bretelle | M70SPC5244 |
| 54 | Pomolo bacchetta | Palm saver | Pommeau baguette | USA 713 |
| 55 | Salvabocca in Nylon cal.44/58 | Nylon muzzle protector | Protecteur de bouche en nylon | USA 560-09 |
| 56 | Luminelli acciaio (extra) | steel Nipple | Cheminée en acier | 800003407 |
| 57 | Chiave luminello | Nipple wrench | Clè de Cheminée | USA 023 |
| 58 | Acciarino completo SX | Complete lock | Platine complète | 080000S473 |
| 59 | Acciarino completo DX | Complete lock | Platine complète | 080000S474 |

(*) Queste viti vanno montate sulla codetta quando il fucile è privo di diottra.