

Frontier

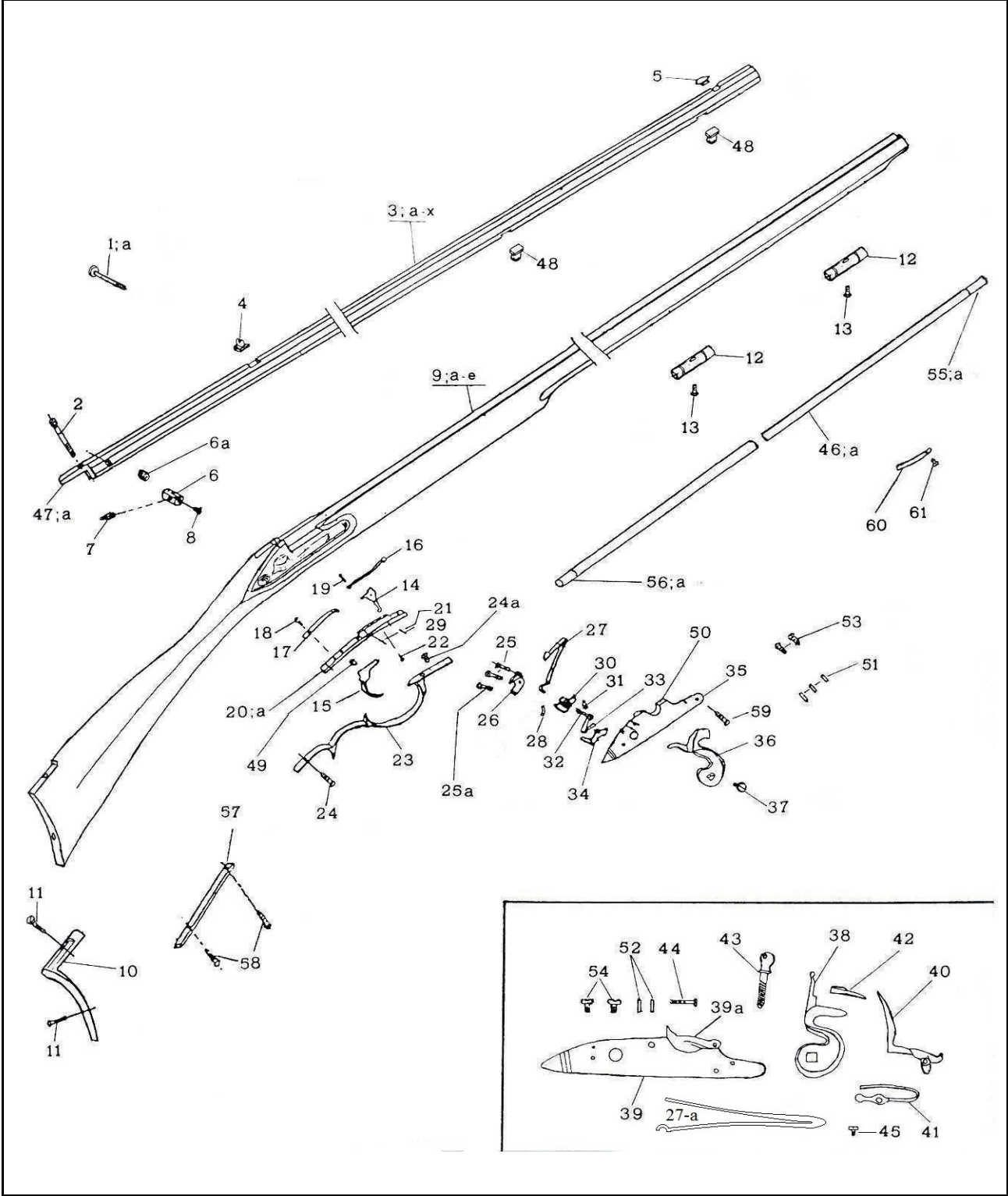

| Nomenclatura / List / Liste | | | | Codice Reference Référence |
|------------------------------------|---|---|--|---|
| No. | Italiano | English | Français | |
| 1 | Vite cartella | Lock plate screw | Vis de platine | M70PFM5433 |
| 1a | Vite cartella per cal. .50 | Lock plate screw for .50 cal. | Vis de platine pour Cal 50 | M70PFM5434 |
| 2 | Vite codetta | Tang screw | Vis de queue de culasse | M70TFM5549 |
| 3 | Canna cal. .32 | Barrel .32 cal. | Canon Cal 32 | 0800002869 |
| 3a | Canna cal. .36 | Barrel .36 cal. | Canon Cal 36 | 0800002651 |
| 3b | Canna cal. .45 | Barrel .45 cal. | Canon Cal 45 | 0800002675 |
| 3c | Canna cal. .50 | Barrel .50 cal. | Canon Cal 50 | 0800002654 |
| 3d | Canna cal. .54 | Barrel .54 cal. | Canon Cal 54 | 0800002806 |
| 3e | Canna cal. .32 finita (a percussione) | Barrel .32 cal., finished (percussion) | Canon Cal 32 ouvragé (à percussion) | 0800P2869A |
| 3f | Canna cal. .32 finita (a pietra focaia) | Barrel .32 cal., finished (flintlock) | Canon Cal 32 ouvragé (à silex) | 0800F2869A |
| 3g | Canna cal. .36 finita (a percussione) | Barrel .36 cal., finished (percussion) | Canon Cal 36 ouvragé (à percussion) | 0800P2651A |
| 3h | Canna cal. .36 finita (a pietra focaia) | Barrel .36 cal., finished (flintlock) | Canon Cal 36 ouvragé (à silex) | 0800F2651A |
| 3i | Canna cal. .45 finita (a percussione) | Barrel .45 cal., finished (percussion) | Canon Cal 45 ouvragé (à percussion) | 0800P2675A |
| 3j | Canna cal. .45 finita (a pietra focaia) | Barrel .45 cal., finished (flintlock) | Canon Cal 45 ouvragé (à silex) | 0800F2675A |
| 3k | Canna cal. .50 finita (a percussione) | Barrel .50 cal., finished (percussion) | Canon Cal 50 ouvragé (à percussion) | 0800P2654A |
| 3l | Canna cal. .50 finita (a pietra focaia) | Barrel .50 cal., finished (flintlock) | Canon Cal 50 ouvragé (à silex) | 0800F2654A |
| 3m | Canna cal. .54 finita (a percussione) | Barrel .54 cal., finished (percussion) | Canon Cal 54 ouvragé (à percussion) | 0800P2806A |
| 3n | Canna cal. .54 finita (a pietra focaia) | Barrel .54 cal., finished (flintlock) | Canon Cal 54 ouvragé (à silex) | 0800F2806A |
| 3o | Canna cal. .32 completa (a percuss.) | Barrel .32 cal. with percussion spares | Canon Cal 32 complet (à percussion) | 0800P2869B |
| 3p | Canna cal. .32 completa (a pietra) | Barrel .32 cal. with flintlock spares | Canon Cal 32 complet (à silex) | 0800F2869B |
| 3q | Canna cal. .36 completa (a percuss.) | Barrel .36 cal. with percussion spares | Canon Cal 36 complet (à percussion) | 0800P2651B |
| 3r | Canna cal. .36 completa (a pietra) | Barrel .36 cal. with flintlock spares | Canon Cal 36 complet (à silex) | 0800F2651B |
| 3s | Canna cal. .45 completa (a percuss.) | Barrel .45 cal. with percussion spares | Canon Cal 45 complet (à percussion) | 0800P2675B |
| 3t | Canna cal. .45 completa (a pietra) | Barrel .45 cal. with flintlock spares | Canon Cal 45 complet (à silex) | 0800F2675B |
| 3u | Canna cal. .50 completa (a percuss.) | Barrel .50 cal. with percussion spares | Canon Cal 50 complet (à percussion) | 0800P2654B |
| 3v | Canna cal. .50 completa (a pietra) | Barrel .50 cal. with flintlock spares | Canon Cal 50 complet (à silex) | 0800F2654B |
| 3w | Canna cal. .54 completa (a percuss.) | Barrel .54 cal. with percussion spares | Canon Cal 54 complet (à percussion) | 0800P2806B |
| 3x | Canna cal. .54 completa (a pietra) | Barrel .54 cal. with flintlock spares | Canon Cal 54 complet (à silex) | 0800F2806B |
| 4 | Tacca di mira | Rear sight | Cran de mire | 0800004855 |
| 5 | Mirino | Front sight | Guidon | 0800003605 |
| 6 | Portaluminello | Drum | Porte-cheminée | 0800004206 |
| 6a | Focone | Vent screw | Lumière | 0800002911 |
| 7 | Luminello | Nipple | Cheminée | 0800003407 |
| 8 | Vite portaluminello | Drum screw | Vis de porte-cheminée | M70TFC5261 |
| 9 | Calcio noce per cal. .32, .36 e .45 | Walnut stock for .32, .36 and .45 cal. | Monture en noyer pour Cal 32, 36 et 45 | 0800003450 |
| 9a | Calcio noce per cal. .50 | Walnut stock for .50 cal. | Monture en noyer pour Cal 50 | 0800003451 |
| 9b | Calcio acero per cal. .32, .36 e .45 | Maple stock for .32, .36 and .45 cal. | Monture en érable pour Cal 32, 36 et 45 | 0800003486 |
| 9c | Calcio acero per cal. .50 | Maple stock for .50 cal. | Monture en érable pour Cal 50 | 0800003487 |
| 9d | Calcio noce per cal. .32, .36 e .45 (finito) | Finished walnut stock (.32, .36 & .45 cal.) | Monture noyer ouvragé (Cal 32, 36 et 45) | 080003450A |
| 9e | Calcio noce per cal. .50 (finito) | Finished walnut stock for .50 cal. | Monture noyer ouvragé (Cal 50) | 080003451A |
| 9f | Calcio acero per cal. .32, .36 e .45 (finito) | Finished maple stock (.32, .36 & .45 cal.) | Monture érable ouvragé (Cal 32, 36 et 45) | 080003486A |
| 9g | Calcio acero per cal. .50 (finito) | Finished maple stock for .50 cal. | Monture érable ouvragé (Cal 50) | 080003487A |
| 9h | Calcio noce completo (cal. .32, .36 e .45) | Walnut stock with spares (.32, .36 & .45) | Monture noyer complète (Cal 32, 36 et 45) | 080003450B |
| 9i | Calcio noce completo per cal. .50 | Walnut stock with spares (.50 cal.) | Monture noyer complète (Cal 50) | 080003451B |
| 9l | Calcio acero completo (cal. .32, .36 e .45) | Maple stock with spares (.32, .36 & .45) | Monture érable complète (Cal 32, 36 et 45) | 080003486B |
| 9m | Calcio acero completo (cal. .50) | Maple stock with spares (.50 cal.) | Monture érable complète (Cal 50) | 080003487B |
| 10 | Calciolo | Butt plate | Plaque de couche | 0800002653 |
| 11 | Vite calciolo | Butt plate screw | Vis de plaque de couche | M70LFC5392 |
| 12 | Ghiera portabacchetta | Thimble | Busette | 0800003063 |
| 13 | Vite ghiera portabacchetta | Thimble screw | Vis de busette | M70PFC5421 |
| 14 | Grilletto anteriore | Front trigger | Détente antérieure | 0800003062 |
| 15 | Grilletto posteriore | Rear trigger | Détente postérieure | 0800003061 |
| 16 | Molla grilletto anteriore | Front trigger spring | Ressort de détente antérieure | 0800003671 |
| 17 | Molla grilletto posteriore | Rear trigger spring | Ressort de détente postérieure | 0800003616 |
| 18 | Vite molla grilletto posteriore | Rear trigger spring screw | Vis du ressort détente postérieure | M70TFC5501 |
| 19 | Vite molla grilletto anteriore | Front trigger spring screw | Vis du ressort détente antérieure | M70PFC5403 |
| 20 | Sottoguardia | Trigger plate | Sous-garde | 0800004662 |
| 20a | Sottoguardia completo | Trigger plate, assembled | Sous-garde complète | 080004662B |
| 21 | Copiglia grilletto | Trigger pin | Goupille de détente | M70COP5521 |
| 22 | Vite regolazione stecher | Set trigger adjusting screw | Vis de réglage double détente | M70PFC5406 |

| Nomenclatura / List / Liste | | | | Codice Reference Référence |
|------------------------------------|--|---|--|---|
| No. | Italiano | English | Français | |
| 23 | Guardamano | Trigger guard | Pontet | 0800003060 |
| 24 | Vite posteriore guardamano | Rear trigger guard screw | Vis postérieure du pontet | M70LFC5392 |
| 24a | Vite anteriore guardamano | Front trigger guard screw | Vis antérieure du pontet | M70TFC5205 |
| 25 | Vite braghetta | Bridle screw | Vis de bride | M70TFM5508 |
| 25a | Vite leva scatto | Sear screw | Vis de gâchette | M70TFM5525 |
| 26 | Braghetta | Bridle | Bride | 0800002207 |
| 27 | Molla cane x percussione | Percussion Mainspring | Grand ressort percussion | 0800003695 |
| 27a | Molla cane x pietra | Flintlock Mainspring | Grand ressort silex | 0800003679 |
| 28 | Tirantino | Stirrup | Chaînette | 0800004892 |
| 29 | Copiglia corta grilletto | Short trigger pin | Goupille courte de détente | M70COP5520 |
| 30 | Noce | Tumbler | Noix | 0800003907 |
| 31 | Farfallina | Fly | Papillon | 0800002906 |
| 32 | Vite molla leva scatto | Sear spring screw | Vis du ressort de gâchette | M70TFC5214 |
| 33 | Molla leva scatto | Sear spring | Ressort de gâchette | 0800003610 |
| 34 | Leva scatto | Sear | Gâchette | 0800003556 |
| 35 | Cartella a percussione | Percussion lock plate | Platine à percussion | 0800002649 |
| 36 | Cane a percussione | Percussion hammer | Chien à percussion | 0800002650 |
| 37 | Vite cane | Hammer screw | Vis du chien | M70PFC5417 |
| 38 | Cane a pietra | Flintlock hammer | Chien à silex | 0800002657 |
| 39 | Cartella a pietra | Flintlock plate | Platine à silex | 0800002502 |
| 39a | Bacinetto | Pan | Bassinnet | 0800002247 |
| 40 | Martellina | Frizzen | Batterie | 0800002656 |
| 41 | Molla martellina | Frizzen spring | Ressort de batterie | 0800003675 |
| 42 | Premipietra | Top jaw | Mâchoire supérieure | 0800004274 |
| 43 | Vite premipietra | Top jaw screw | Vis des mâchoires | M70SPC5466 |
| 44 | Vite martellina | Frizzen screw | Vis de batterie | M70TFM5528 |
| 45 | Vite molla martellina | Frizzen spring screw | Vis du ressort de batterie | M70TFC5502 |
| 46 | Bacchetta completa (cal. .36) | Ramrod with tips (.36 cal.) | Baguette complète (Cal 36) | 0800002294 |
| 46a | Bacchetta completa (cal. .45 e .50) | Ramrod with tips (.45 and .50 cal.) | Baguette complète (Cal 45 et 50) | 0800002246 |
| 46b | Bacchetta completa (cal. .32) | Ramrod with tips (.32 cal.) | Baguette complète (Cal 32) | 036U747320 |
| 47 | Tappo canna cal. .32, .36 e .45 | Breech plug .32, .36 and .45 cal. | Bouchon de culasse (Cal 32, 36 et 45) | 0800004874 |
| 47a | Tappo canna cal. .50 | Breech plug .50 cal. | Bouchon de culasse (Cal 50) | 0800004875 |
| 47b | Tappo canna cal. .54 | Breech plug .54 cal. | Bouchon de culasse (Cal 54) | 0800004988 |
| 48 | Tenone per vite ghiera | Tenon for thimble screw | Tenon pour vis de busette | 0800004889 |
| 49 | Grano regolazione molla caricam. stecher | Screw for regulation set trigger spring | Vis réglage du ressort de double détente | M700ST5308 |
| 50 | Zocchetto per cartella a percussione | Plaque for percussion lock plate | Plateau pour platine à percussion | 0800005296 |
| 51 | Copiglia per zocchetto | Plaque pin | Goupille pour plateau de platine | M70COP5224 |
| 52 | Copiglia bacinetto | Pan pin | Goupille de bassinet | M70COP5224 |
| 53 | Vite per zocchetto | Plaque screw | Vis pour plateau de platine | M70TFM5225 |
| 54 | Vite bacinetto | Pan screw | Vis du bassinet | M70TFM5225 |
| 55 | Puntale anteriore bacchetta (cal. .36) | Front ramrod tip (Cal. .36) | Refouloir (Cal 36) | 0800004209 |
| 55a | Puntale anteriore bacchetta (cal. .45/.50) | Front ramrod tip (.45 and .50 cal.) | Refouloir (Cal 45 et 50) | 0800004343 |
| 56 | Puntale posteriore bacch. (cal. .36) | Rear ramrod tip (Cal. .36) | Embout postérieur baguette (Cal 36) | 0800004215 |
| 56a | Puntale posteriore bacch. (cal. .45/.50) | Rear ramrod tip (.45 and .50 cal.) | Embout postérieur baguette (Cal 45/50) | 0800004214 |
| 57 | Piastrina calciolo | Toe plate | Platine de plaque de couche | 0800004205 |
| 58 | Vite piastrina | Toe plate screw | Vis platine de plaque | M70LFC5392 |
| 59 | Vite cartella | Lock plate screw | Vis de platine | M70LFC5285 |
| 60 | Molla bacchetta | Ramrod spring | Ressort de baguette | 0800003655 |
| 61 | Vite molla bacchetta | Ramrod spring screw | Vis du ressort de baguette | M70LFC5384 |